



Oasis House, Deer Park, Industrial Estate, Knowle Lane
Fair Oak, Eastleigh, Hants SO50 7PZ
Phone: 0 23 8060 2602 - Fax: 0 23 8060 2603
www.oasis-water-gardens.com

Dealer's stamp and signature
Dealerstempel en handtekening
Cachet et signature du commerçant
Stempel und Unterschrift des Händlers

[Empty box for dealer's stamp and signature]

Date of purchase
Koopdatum

Date de l'achat
Kaufdatum

[Empty box for date of purchase]



N° B 22080
2005

Pressure Tec

Instructions



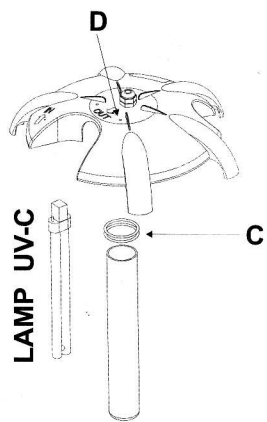
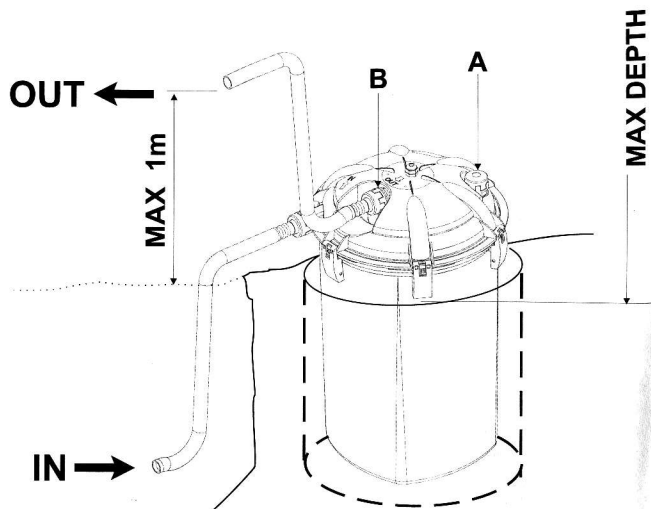

033.AB.011-PRESSURE TEC COMBI 7000/9000
 033.AB.010-PRESSURE TEC COMBI 15000

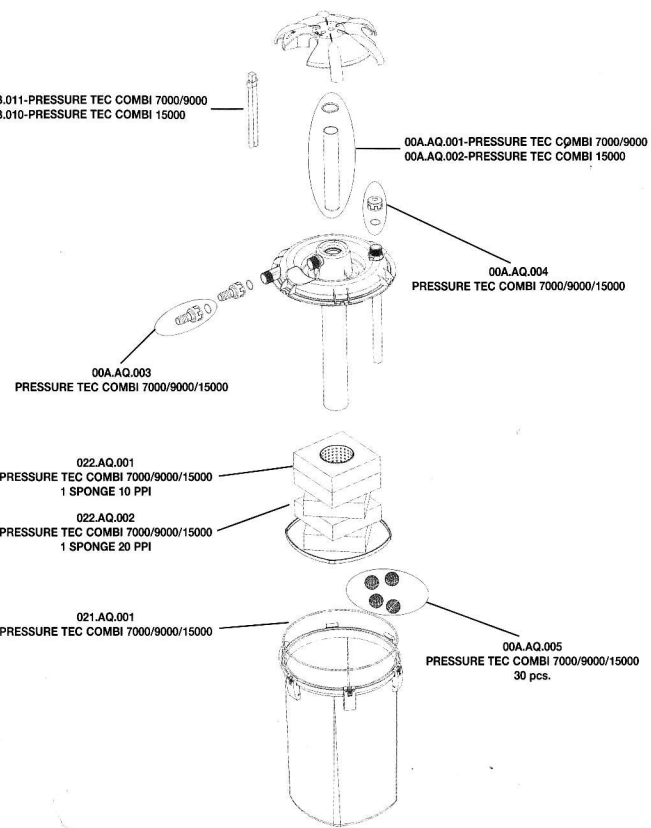

00A.AQ.001-PRESSURE TEC COMBI 7000/9000
 00A.AQ.002-PRESSURE TEC COMBI 15000

00A.AQ.004
 PRESSURE TEC COMBI 7000/9000/15000

00A.AQ.003
 PRESSURE TEC COMBI 7000/9000/15000

022.AQ.001
 PRESSURE TEC COMBI 7000/9000/15000
 1 SPONGE 10 PPI

022.AQ.002
 PRESSURE TEC COMBI 7000/9000/15000
 1 SPONGE 20 PPI

021.AQ.001
 PRESSURE TEC COMBI 7000/9000/15000

00A.AQ.005
 PRESSURE TEC COMBI 7000/9000/15000
 30 pcs.

Pressure- Tec Combi Filter

The Oasis Pressure-Tec Filter is supplied with both mechanical and biological filtration media and an ultraviolet clarifier fitted as standard.

Instructions for Use

Always unplug the appliance from power supply before assembling, dismantling or cleaning.

Always follow the installation instructions given below.

Do not use the pressure filter for anything other than its intended purpose.

Installation

- Choose the most suitable place for installation. i.e. a firm level base.
- The Pressure-Tec filter can be buried up to the height of the sealing clips. Connect the pump to the filter inlet adapter marked with the "IN" symbol by using suitable length of aquatic flexible hosepipe.
- Connect a suitable length of flexible hosepipe to the outlet marked with the "OUT" symbol for the return of water to your pond or to a waterfall.
- Check that the hose pipe returning the water to your pond or waterfall is no higher than 1metre above the position of the pressure-Tec filter. (See fig.).
- Check that the ultraviolet clarifier (UV-C) light works (the top decorative cover lights up (D)).

Maintenance

The Pressure-Tec filter has a rapid backwash cleaning system. Before cleaning ensure that the pump is turned off. Unscrew the backwash plug (A) and use it to close the delivery pipe (B). Connect a hose to the backwash and turn the pump on. In this manner, any dirt that has built up on the grid and the out side of the sponge is expelled.

The Bio Balls must be cleaned twice a year in a bucket containing pond water (never use tap water). If there is an increase of algae in the pond, check that the UV-C device is working correctly (the lamp must be changed after 9000 working hours). If the light is working correctly, then the quartz glass tube, which contains the lamp, must be cleaned. Ensure the power is turned

off beforehand to both the pump and the UV-C, then unscrew the 4 screws on the decorative cover (D). Pull out the lamp and the glass tube, clean any lime scale deposits on the tube with a clean rag. Re-assemble the entire unit checking that the seals (C) are in the right position.

Operations

	MAX FLOW	POND	UVC
PRESSURE TEC 7000	1700-2500 L/H 377-555 Gall/h	7000 L 1555 Gall	9 W
PRESSURE TEC 9000	2500-3200 L/H 555-711 Gall/h	9000 L 2000 Gall	9 W
PRESSURE TEC 15000	3200-6500 L/H 711-1444 Gall/h	15000 L 3333 Gall	11 W

The Pressure-Tec filter has been designed to give the best performance with the range of Aquashift ST Dirty water pumps by Oasis Water Garden Products Ltd. If your pump has a flow rate higher than required, we recommend using a flow adjuster to decrease water flow.

Safety

- If the appliance is not used during the winter, it must be removed from the pond to avoid the risk of it freezing.
- This appliance is fitted with a UV-C light, never look directly at the lamp when illuminated.
- To avoid the lamp over heating, never run the unit without the pump running.

Guarantee Conditions

Your Pressure-Tec Filter is guaranteed against failure due to defective workmanship or materials for a period of 2 years from the date of purchase. Failure caused by accidental damage, misuse, neglect or used in liquids other than cold water are excluded from this Guarantee. If a failure occurs during this period, a purchase receipt must be returned with the unit which will be repaired or replaced, after inspection. The company can not accept any additional claims for consequential losses.

**THIS GUARANTEE DOES NOT AFFECT YOUR STATUTORY RIGHTS.
THIS UNIT IS MADE IN THE E.C. AND CONFORMS TO REGULATIONS**